

## **LEE BARON** Three of the best from 2020



## Three of the best from 2020



PTSG and Lee Baron are currently shortlisted for the Partners in Cleaning Award in the PFM Partnership Awards 2020 (the ceremony will take place in March 2021).

The working relationship between the two organisations is one of the most successful in PTSG's history – Lee Baron has renewed its contract with PTSG every year for the last ten years. During that time PTSG's Building Access Specialists have provided a growing number of high-level services at Dickens Yard – an exclusive residential development in Ealing, comprised of seven tower blocks up to 15 storeys in height, with 20 shops at ground level.

### Testing and inspection

PTSG tests and inspects the Mansafe Systems on a 12-monthly basis in line with EN795 – the current legislation.

The abseil anchors designed and installed for rope access use are tested every six months to meet the lifting regulation LOLER 1998.

### High-level cleaning

Façade/window cleaning services range from the regular three-monthly window cleaning to all external glazing. They also include the removal of graffiti, to coping and stone cleaning in areas affected by a build-up of algae or limescale. PTSG also performs a periodic inspection of the balcony fixings on all eight apartment blocks. As a result of vibrations from nearby rail services, fixings are prone to working loose from time to time. PTSG's inspections and maintenance works ensure they are 100% safe and fit for purpose.

Aside from the quality of workmanship, what has distinguished this project over the years is the close collaborative working relationship between PTSG and Lee Baron. PTSG reports back any observations of the general condition of any of the development during our visits and works. Site-specific risk assessments and method statements are written for each of the tasks detailed above, reviewed and then approved by Lee Baron prior to any attendance.



This offered a streamlined project contact structure,  
a streamlined design structure and a better  
commercial proposition

## Partners in Expert Services: PTSG and Imtech at Freeman's Common

PTSG and Imtech are also shortlisted in the PFM Partnership Awards 2020 in the Partners in Expert Services category.

The two organisations worked extensively together at Freeman's Common, a new-build development on behalf of the University of Leicester, consisting of 1,200 high-quality student residences, as well as a new multi-storey car park.

## Scope of Works

UK Sprinklers Ltd, a constituent company of Premier Technical Service Group Ltd (PTSG) was appointed to design, install, test and commission packages of residential sprinklers and dry risers to the student accommodation blocks and the multi-storey car park. Utilising the experience of our sister company UK Dry Risers Ltd, we were able to offer a single point of contact and single package delivery across the two service disciplines, offering a streamlined process and single project team.

One of the biggest challenges in the project was the complexity of the site, which comprised seven accommodation blocks served by three sets of plant infrastructure.

PTSG engaged with early technical input as well as early hydraulic calculations in conjunction with Imtech's design team to ensure that the anticipated demand requirements for the sprinklers could be accommodated. This in turn also allowed us to provide early information to ensure the sizing of the pumps/tanks were correct.

PTSG managed the joint bid – encompassing the provision of sprinkler systems and dry risers. This offered a streamlined project contact structure, a streamlined design structure and a better commercial proposition for the client than would have been achieved through two separate packages of work.





# Three of the best from 2020

## PTSG employs great innovation at Channel 4

The following sequence of pictures and captions describes the main part of an extremely difficult and complex specialist services project at the headquarters of Channel 4 in Westminster.

1. Engineers from PTSG Access & Safety Ltd were given the task of replacing the Building Maintenance Unit (BMU) from the inside of the main reception in Horseferry Road. A BMU or cradle system enables users to safely work at height to carry out specialist services such as window cleaning and glazing maintenance. PTSG Access and Safety Ltd is the largest provider of cradle maintenance services for permanently installed suspended access equipment in the UK.
2. Its engineers were unable to lift the BMU from the outside of the building, as the atrium glazing hangs from an exoskeleton structure, which prevents access.
3. To resolve this, a specially designed scaffold was erected in such a way that the

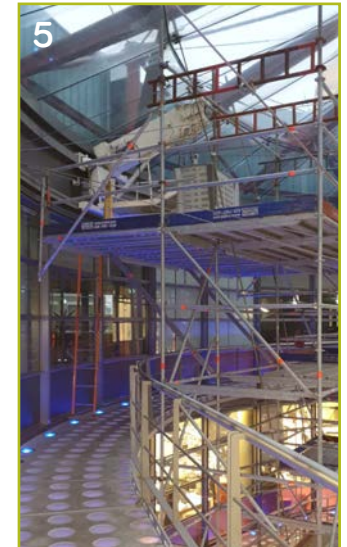
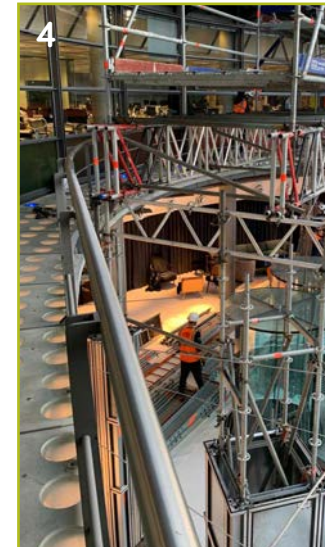
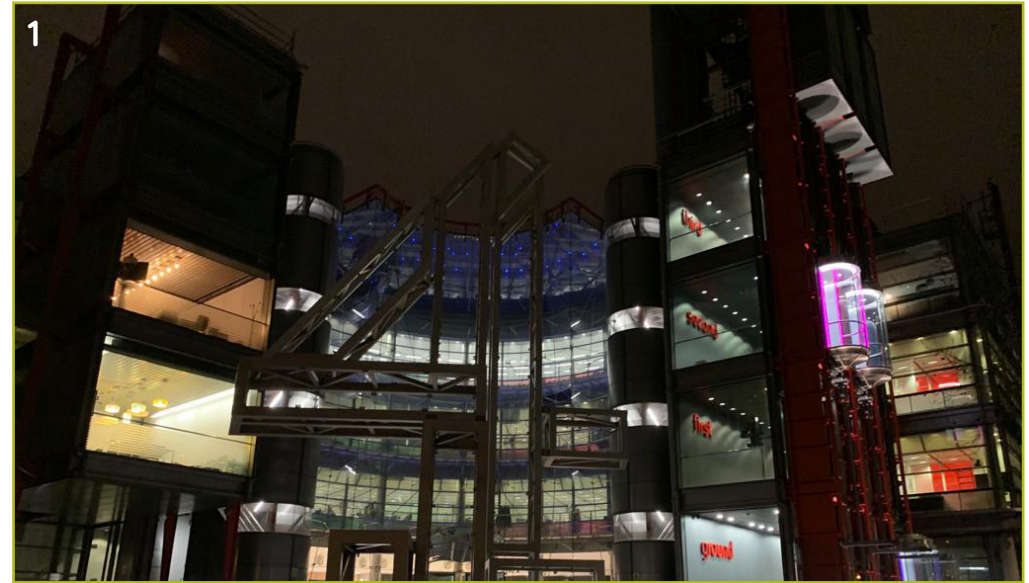



# Three of the best from 2020

6. (and 7, 8 and 9) PTSG removed the cradle in sections and lifted it down the scaffold for disposal.

10. (and 11-15) The new machine was lifted up in sections and erected in place on the tracks.

Channel 4 is a British public-service free-to-air television network headquartered in London, United Kingdom. The channel was established to provide a fourth television service to the United Kingdom in addition to the licence-funded BBC One and BBC Two, and the single commercial broadcasting network ITV. It began transmission on 2 November 1982.

